

O-I Manufacturing Italy S.p.A.
 via Washington, 70
 20146 Milano, Italy
 Tel. +39 0243463.1

CONTAINER & MOULD ENGINEERING
EUROPE

NOTES:
 THIS DRAWING IS THE PROPERTY OF O-I AND
 MUST NOT BE REPRODUCED OR DISCLOSED
 WITHOUT O-I WRITTEN AUTHORIZATION.
 ONLY TOLERANCED DIMENSIONS ARE GUARANTEED.
 MANUFACTURING MARKINGS SHOWN ARE FOR ILLUSTRATIVE
 PURPOSES ONLY; ACTUAL MARKINGS ON CONTAINER
 MAY DIFFER, DEPENDANT ON LOCAL LEGISLATION.

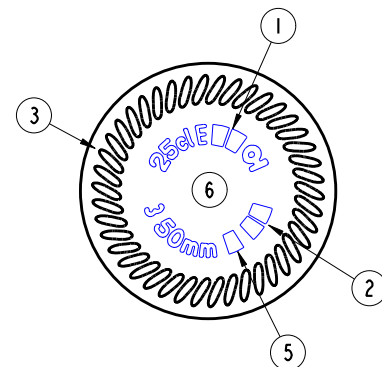
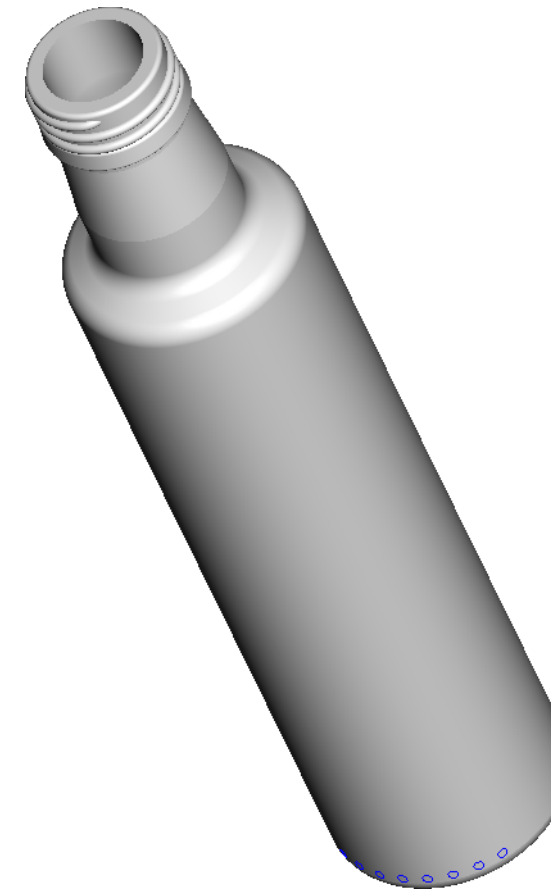
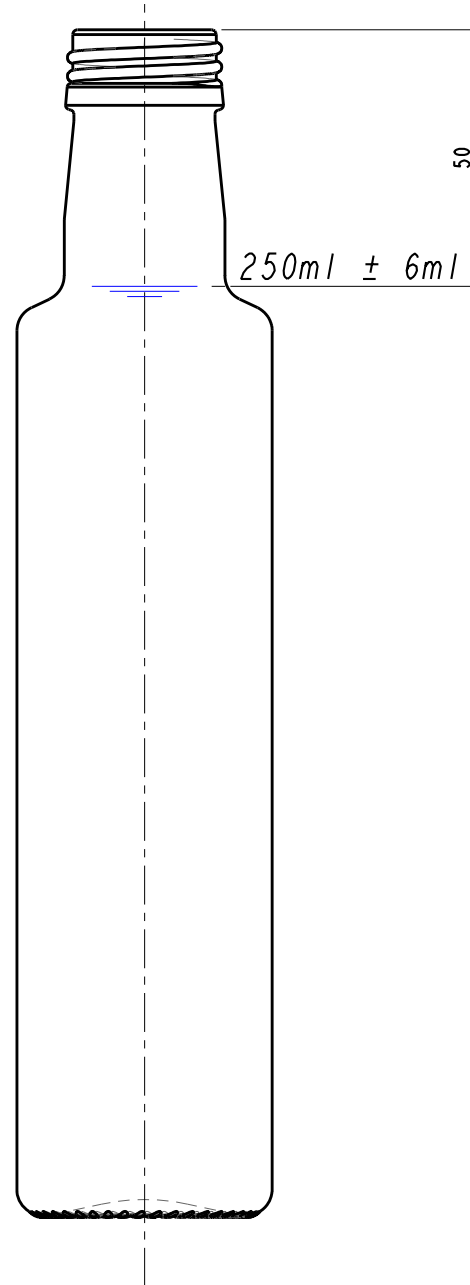
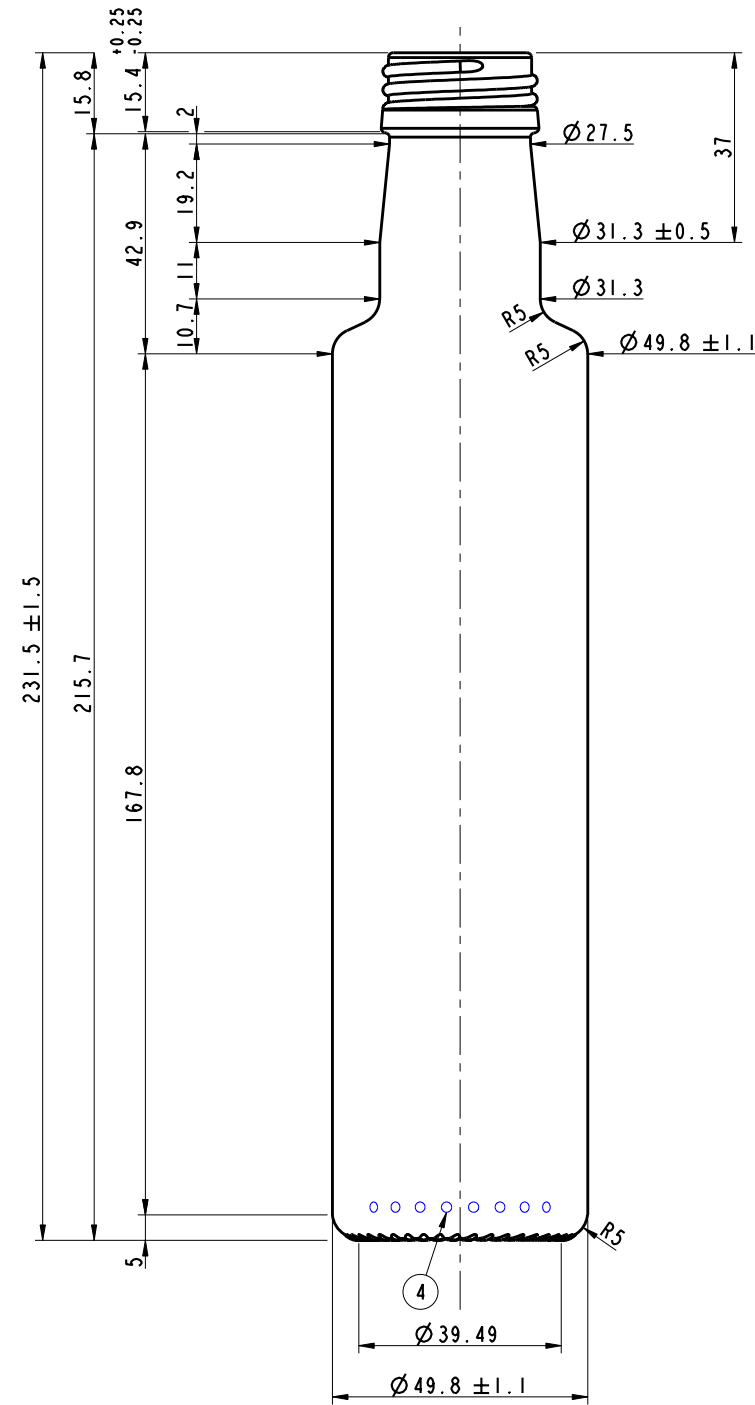

1 = TRADEMARK
 2 = CAVITY No.
 3 = STIPPLING
 THE SHAPE OF STIPPLES IS ONLY AN
 INDICATION AND THE CONSTRUCTION IS AT
 THE PRODUCTION PLANT DISCRETION.
 4 = CAVITY CODE
 5 = A GLASS IDENTIFICATION
 6 = KNURLING AT PLANT DISCRETION

SCALE 1:1

TENTATIVE

CATEGORY FOOD		TILT ANGLE 11.67°	
MAX. VERTICALITY TOLERANCE 2.6 mm		MEASURING CONTAINER YES	
FINISH SAP NUMBER 0841		FINISH REF. UNI 6144 1988	
MINIMUM THROUGH BORE 18.5 mm		MAX FILLING TUBE Ø 17 mm	
CONTAINER OVERFLOW CAPACITY (BRIMFUL) 270ml APPROX.			
CONTAINER RATED CAPACITY (FILLPOINT) 250ml ± 6ml			
CONTAINER WEIGHT 270g APPROX.			
FINISH DESIGNATION IT_32_UNI 6144_HI58_0841		MAX GAS VOLUME	
PROCESS	RETURNABLE NO	DESIGN REF.	
STANDARD 25 cl DORICA			
DESIGNER	GP	DATE	19/11/09
CHECKED		DATE	
DRAWING NUMBER 090849		MOULD/SAP NUMBER 00000	

No	DATE	REVISIONS	DESIGN/CHECK